

- NOTES:**
This Site Plan does not show widths or construction details
- Borough/Parish Boundary
 - Public Right of Way
- KEY:**
- Highway Boundary
 - Classified Roads
 - Highway to be stopped up
 - Highway to be improved
 - New Highway
 - Private Means of Access to be stopped up
 - New Means of Access

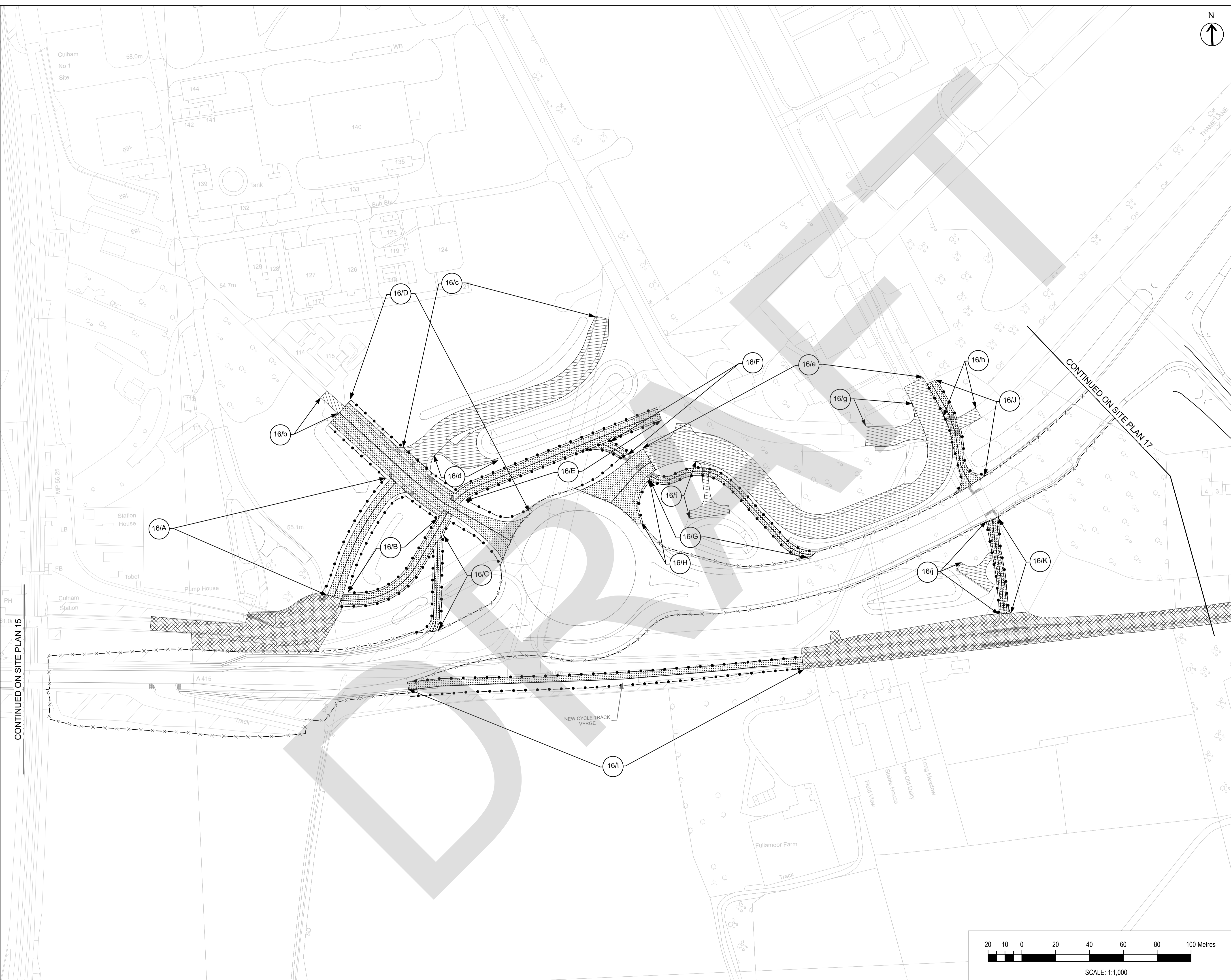

CONTINUED ON SITE PLAN 15

CONTINUED ON SITE PLAN 17

Rev	Description	Date	By	Check	Approved

This map is reproduced from Ordnance Survey material with the permission of Ordnance Survey on behalf of the Controller of Her Majesty's Stationery Office. © Crown Copyright. Unauthorised reproduction infringes Crown Copyright and may lead to prosecution or civil proceedings. Oxfordshire County Council, 0100023343, 2021



THE OXFORDSHIRE COUNTY COUNCIL (DIDCOT GARDEN TOWN HIGHWAYS INFRASTRUCTURE - A4130 IMPROVEMENT (MILTON GATE TO COLLETT ROUNDABOUT), A4197 DIDCOT TO CULHAM LINK ROAD, AND A415 CLIFTON HAMPDEN BYPASS (SIDE ROADS) ORDER 2022

SITE PLAN 16 -
A415 CLIFTON HAMPDEN BYPASS - CULHAM STATION AND CULHAM SCIENCE CENTRE

The COMMON SEAL of Oxfordshire County Council was hereunto affixed in the presence of -

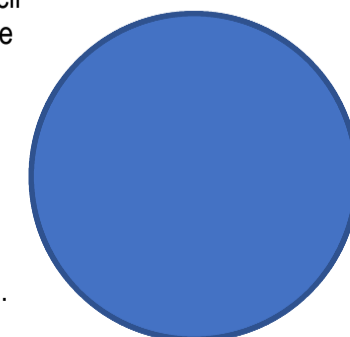

Authorised Officer
Dated this day of 2022 Seal No.

Drawn	Checked	Approved	Date
AH	**	**	06/07/22

GH Project Number 132861.001 Scale at A1 1:1,000

Drawing Number GH-132861001-SRO-16 Revision P01.4

